

INSTALLATION INSTRUCTIONS

DESCRIPTION: Rear Receiver Hitch Mount Kit
PART NUMBER: B16-F85H0-V0
MODEL: Kodiak 700



⚠ WARNING

Please read and understand these instructions completely before installation to avoid possible injury, or damage to the accessory or vehicle.

NOTICES:

This installation requires a torque wrench and should be performed by an authorized Yamaha dealer or other qualified technician.

WARRANTY INFORMATION:

Genuine Yamaha Accessories are covered by a one-year limited warranty against defects in material or workmanship. Labor for replacement of defective components is not covered. See your Yamaha dealer for a copy of the warranty statement.

DEALER OR INSTALLER:

These instructions contain important information for future reference and *must* be given to the customer.

PARTS LIST:

No.	Part Number	Description	Qty
--	B16-F85H0-V0	Rear Receiver Hitch Mount Kit	--
①	*	Rear Receiver Hitch	1
②	*	Flange Bolt	4

* Part supplied with kit only and not available separately.

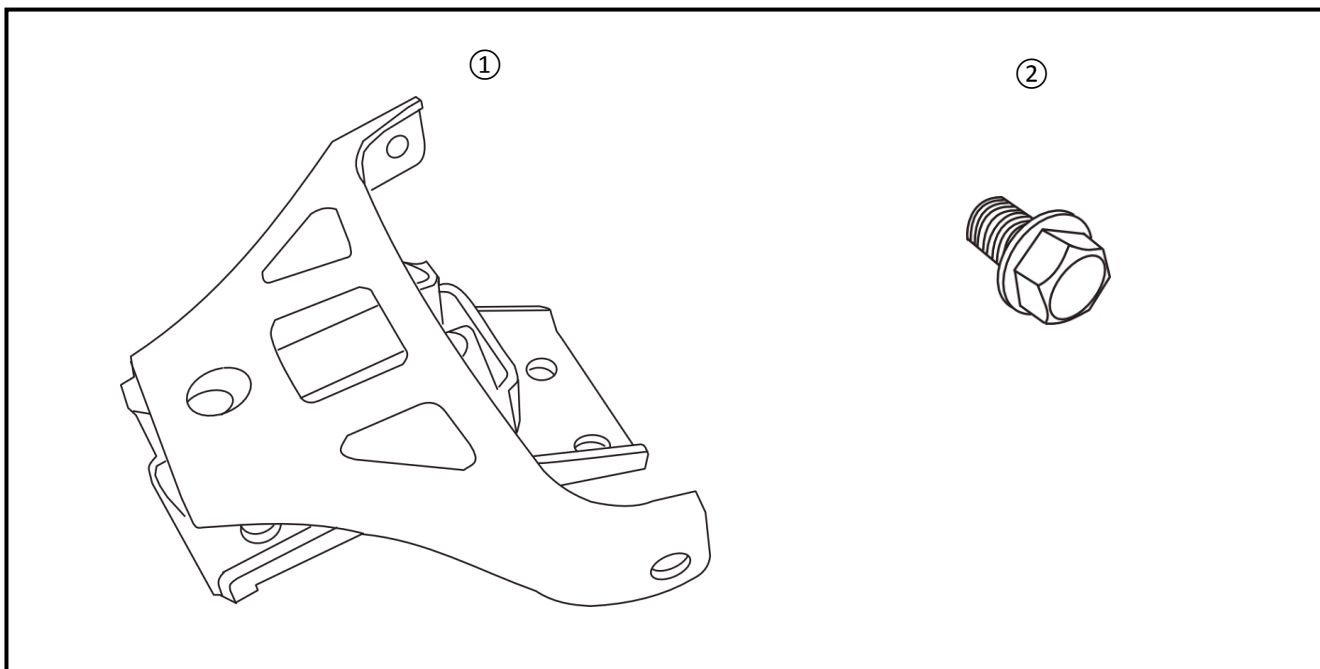

Fig. 1

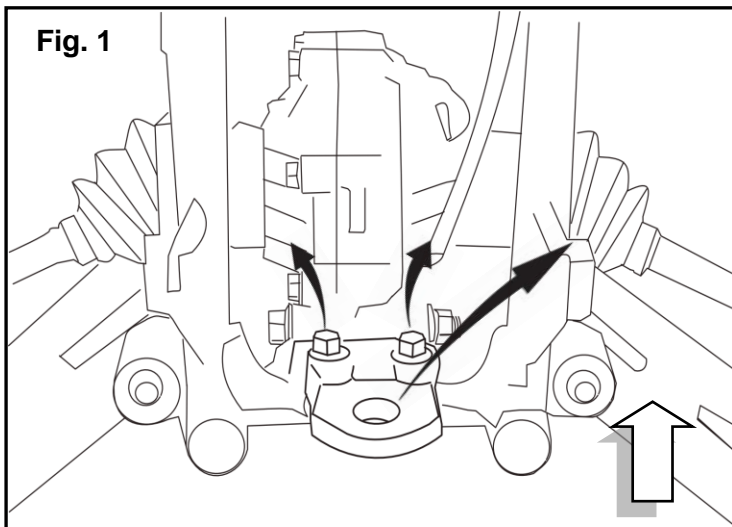

Fig. 2

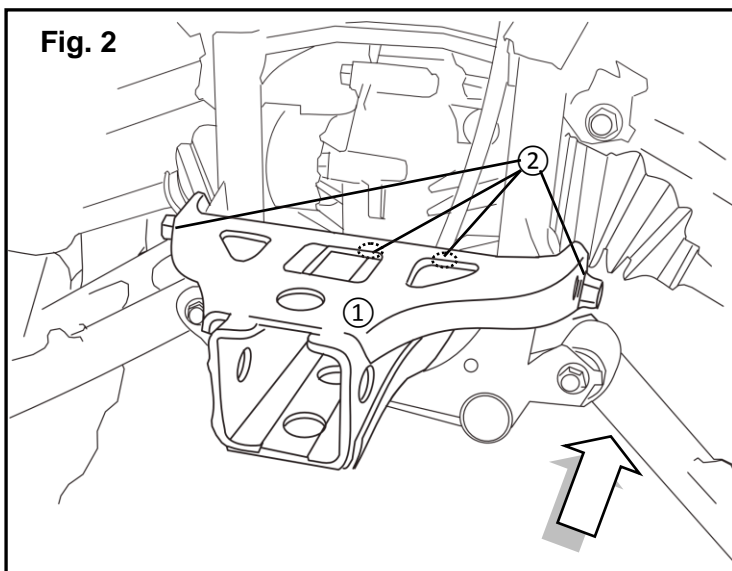
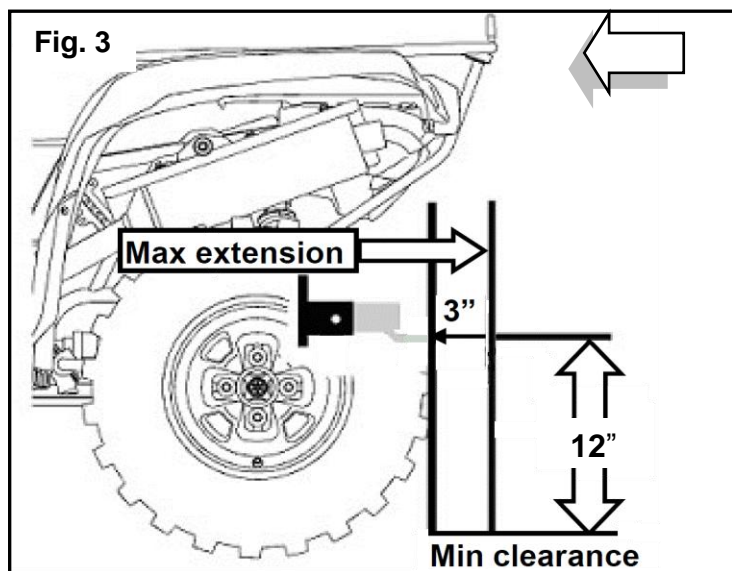

Fig. 3



PREPARATION:

- Place the vehicle on a secure and level surface.
- Set the parking brake.
- Clean the mount surfaces before starting installation.

INSTALLATION:

1. Working from the center rear of the vehicle, remove the two bolts securing the stock hitch tongue. None of these parts are reused for this installation. (Fig. 1)
2. Install the Rear Receiver hitch ①. Install 2 Flange Bolts ② through the mount holes in the Receiver hitch and into the center mount holes. *These are the same holes you removed the bolts from in step 1.
3. Install 2 Flange Bolts ② through the side mount holes and into the threaded mount holes (Fig. 2).
4. Torque flange bolts to 55Nm (5.6 M-kg, 40.6 Ft-lb).

⚠WARNING

Remove the ball mount when the hitch is not in use. When choosing a ball mount for your applications ensure the mount:

- Does not extend more than 3 inches past the rear tires
- Does not extend below the stock hitch mount. Clearance from the ground to the ball mount should not be less than 12".

See Fig. 3

MAINTENANCE:

Periodically, check torque and tightness on all hardware. If loose hardware is found, re-torque or re-tighten.

CARE AND CLEANING:

Clean painted metal parts with a clean soft cloth and mild soap and water. Rinse and dry.

CUSTOMER SERVICE:

For further information see your Yamaha dealer.

ESTIMATED TIME TO INSTALL: 0.3 HRS